

KITCHEN & UTILITY DESIGN PACK

CUSTOMER NAME

Sample Pack 2

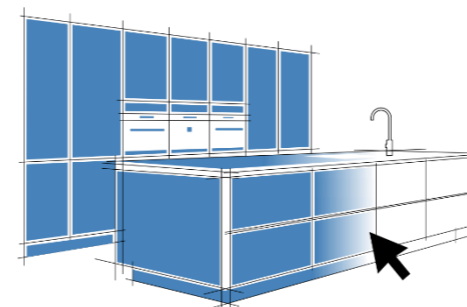

DESIGN A
KITCHEN
— WE DESIGN. YOU SAVE —

KITCHEN CAD VISUAL - BIRDSEYE



| | | | |
|---------------|--------------------|----------------------|--|
| Customer Name | Design Revision No | Design Revision Date | DESIGN A KITCHEN (UK) LIMITED |
| Sample Pack 2 | 1 | | Tel No Email enquiries@designakitchen.co.uk Web www.designakitchen.co.uk |

PLEASE NOTE: All dimensions are for guidance only. A thorough site survey should be conducted by the kitchen retailer and/or installer before any cabinets, accessories, appliances and worksurfaces are purchased to validate all dimensions and check technical suitability of all products.

KITCHEN CAD VISUAL 1



| Customer Name | Design Revision No | Design Revision Date | DESIGN A KITCHEN (UK) LIMITED |
|---------------|--------------------|----------------------|--|
| Sample Pack 2 | 1 | | Tel No Email enquiries@designakitchen.co.uk Web www.designakitchen.co.uk |

PLEASE NOTE: All dimensions are for guidance only. A thorough site survey should be conducted by the kitchen retailer and/or installer before any cabinets, accessories, appliances and worksurfaces are purchased to validate all dimensions and check technical suitability of all products.

KITCHEN CAD VISUAL 2



| | | | |
|---------------|--------------------|----------------------|--|
| Customer Name | Design Revision No | Design Revision Date | DESIGN A KITCHEN (UK) LIMITED |
| Sample Pack 2 | 1 | | Tel No Email enquiries@designakitchen.co.uk Web www.designakitchen.co.uk |

PLEASE NOTE: All dimensions are for guidance only. A thorough site survey should be conducted by the kitchen retailer and/or installer before any cabinets, accessories, appliances and worksurfaces are purchased to validate all dimensions and check technical suitability of all products.

KITCHEN CAD VISUAL 3



| | | | |
|---------------|--------------------|----------------------|--|
| Customer Name | Design Revision No | Design Revision Date | DESIGN A KITCHEN (UK) LIMITED |
| Sample Pack 2 | 1 | | Tel No Email enquiries@designakitchen.co.uk Web www.designakitchen.co.uk |

PLEASE NOTE: All dimensions are for guidance only. A thorough site survey should be conducted by the kitchen retailer and/or installer before any cabinets, accessories, appliances and worksurfaces are purchased to validate all dimensions and check technical suitability of all products.

KITCHEN CAD VISUAL 4



| | | | |
|---------------|--------------------|----------------------|--|
| Customer Name | Design Revision No | Design Revision Date | DESIGN A KITCHEN (UK) LIMITED |
| Sample Pack 2 | 1 | | Tel No Email enquiries@designakitchen.co.uk Web www.designakitchen.co.uk |

PLEASE NOTE: All dimensions are for guidance only. A thorough site survey should be conducted by the kitchen retailer and/or installer before any cabinets, accessories, appliances and worksurfaces are purchased to validate all dimensions and check technical suitability of all products.

KITCHEN CAD VISUAL 5



| | | | |
|---------------|--------------------|----------------------|--|
| Customer Name | Design Revision No | Design Revision Date | DESIGN A KITCHEN (UK) LIMITED |
| Sample Pack 2 | 1 | | Tel No Email enquiries@designakitchen.co.uk Web www.designakitchen.co.uk |

PLEASE NOTE: All dimensions are for guidance only. A thorough site survey should be conducted by the kitchen retailer and/or installer before any cabinets, accessories, appliances and worksurfaces are purchased to validate all dimensions and check technical suitability of all products.

KITCHEN ANNOTATED WIREFRAME PLAN

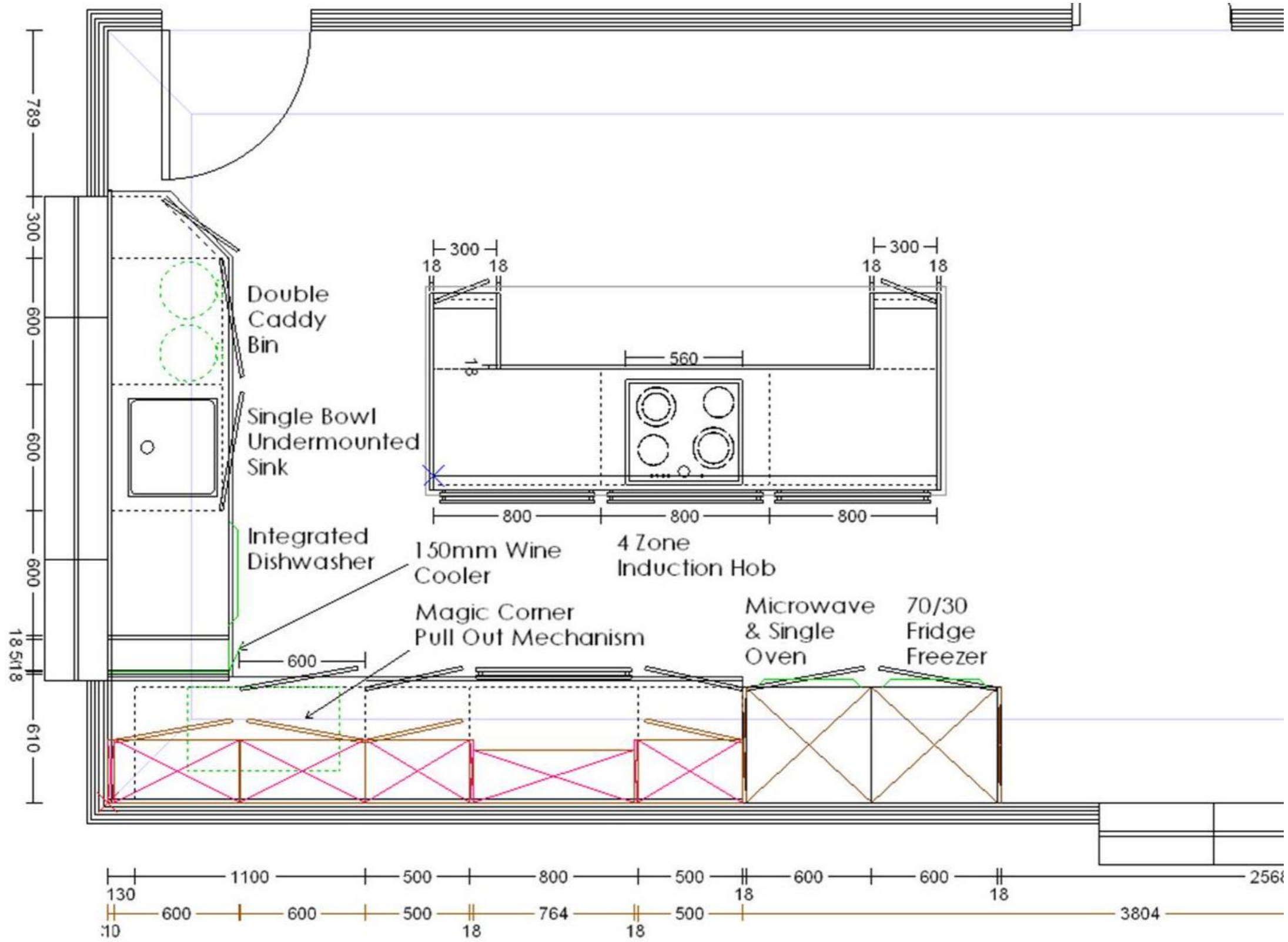

| | | | |
|---------------|--------------------|----------------------|--|
| Customer Name | Design Revision No | Design Revision Date | DESIGN A KITCHEN (UK) LIMITED |
| Sample Pack 2 | 1 | | Tel No Email enquiries@designakitchen.co.uk Web www.designakitchen.co.uk |

PLEASE NOTE: All dimensions are for guidance only. A thorough site survey should be conducted by the kitchen retailer and/or installer before any cabinets, accessories, appliances and worksurfaces are purchased to validate all dimensions and check technical suitability of all products.

KITCHEN PART LIST WIREFRAME PLAN

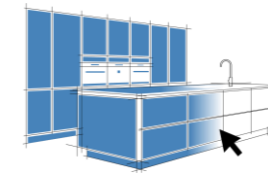

DESIGN A KITCHEN
- WE DESIGN. YOU SAVE -

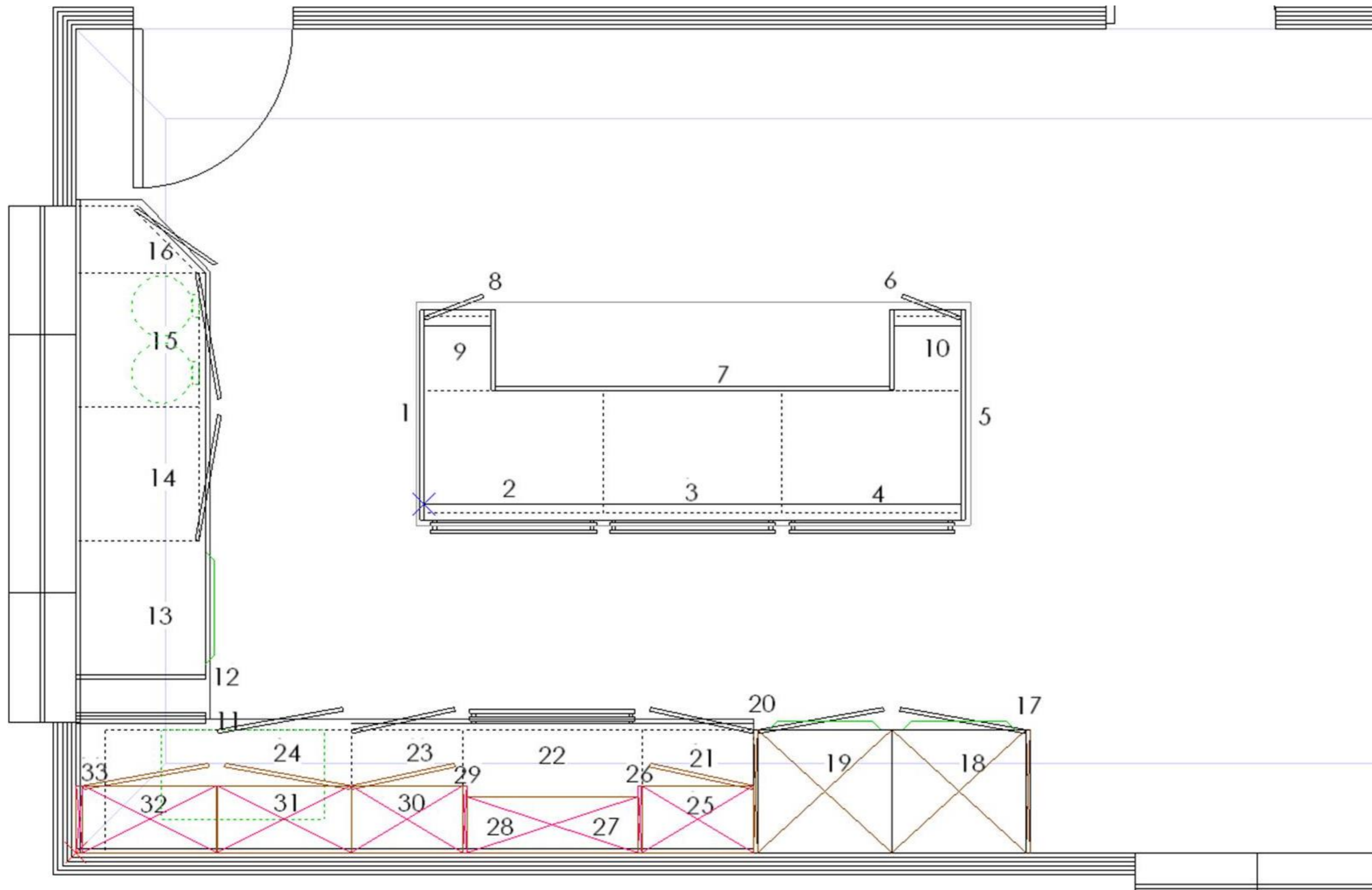

| | | | |
|---------------|--------------------|----------------------|--|
| Customer Name | Design Revision No | Design Revision Date | DESIGN A KITCHEN (UK) LIMITED |
| Sample Pack 2 | 1 | | Tel No Email enquiries@designakitchen.co.uk Web www.designakitchen.co.uk |

PLEASE NOTE: All dimensions are for guidance only. A thorough site survey should be conducted by the kitchen retailer and/or installer before any cabinets, accessories, appliances and worksurfaces are purchased to validate all dimensions and check technical suitability of all products.

KITCHEN PART LIST WIREFRAME PLAN



Base & Tall Units

1. 18mm End Support Panel (Door Colour), Depth = 940mm, Height = 870mm
2. 800mm 2 Drawer Pack with User options, Depth = 580mm, Height = 870mm
2 X 355mm by 796mm Pan Drawer
3. 800mm 2 Drawer Pack with User options, Depth = 580mm, Height = 870mm
2 X 355mm by 796mm Pan Drawer
4. 800mm 2 Drawer Pack with User options, Depth = 580mm, Height = 870mm
2 X 355mm by 796mm Pan Drawer
5. 18mm End Support Panel (Door Colour), Depth = 940mm, Height = 870mm
6. 18mm End Support Panel (Door Colour), Depth = 360mm, Height = 870mm
7. 18mm End Support Panel (Door Colour), Depth = 1764mm, Height = 870mm
8. 18mm End Support Panel (Door Colour), Depth = 360mm, Height = 870mm
9. 300mm Base Unit (Full Height Door), Depth = 360mm, Height = 870mm
1 X 715mm by 296mm Base Unit Door (Right Hand Hinged)
10. 300mm Base Unit (Full Height Door), Depth = 360mm, Height = 870mm
1 X 715mm by 296mm Base Unit Door (Left Hand Hinged)
11. 18mm End Support Panel (Door Colour), Depth = 580mm, Height = 870mm
12. 18mm End Support Panel (Door Colour), Depth = 580mm, Height = 870mm
13. 600mm Integrated Dishwasher Pull Down Door, Depth = 580mm, Height = 870mm
1 X 715mm by 596mm Pan Drawer
14. 600mm Base Unit (Full Height Door), Depth = 580mm, Height = 870mm
1 X 715mm by 596mm Base Unit Door (Left Hand Hinged)
15. 600mm Base Unit (Full Height Door), Depth = 580mm, Height = 870mm
1 X 715mm by 596mm Base Unit Door (Right Hand Hinged)
16. 300mm Angled Base Unit RH (Full Height Door), Depth = 580mm, Height = 870mm
1 X 715mm by 421mm Base Unit Door (Right Hand Hinged)
17. 18mm Tall End Support (Door Colour), Depth = 580mm, Height = 2120mm
18. 600mm Tall Fridge Housing, Depth = 580mm, Height = 2120mm
1 X 715mm by 596mm Base Unit Door (Left Hand Hinged)
1 X 1245mm by 596mm Wall Unit Door (Left Hand Hinged)
19. 600mm Tall Oven Housing, Depth = 580mm, Height = 2120mm
1 X 435mm by 596mm Wall Unit Door (Right Hand Hinged)
2 X 280mm by 596mm Pan Drawer
20. 18mm Tall End Support (Door Colour), Depth = 580mm, Height = 2120mm
21. 500mm Base Unit (Full Height Door), Depth = 580mm, Height = 870mm
1 X 715mm by 496mm Base Unit Door (Left Hand Hinged)
22. 800mm 2 Drawer Pack with User options, Depth = 580mm, Height = 870mm
2 X 355mm by 796mm Pan Drawer

23. 500mm Base Unit (Full Height Door), Depth = 580mm, Height = 870mm
1 X 715mm by 496mm Base Unit Door (Right Hand Hinged)
24. 1100mm Right Hand Corner Base (Full Height Door), Depth = 580mm, Height = 870mm
1 X 715mm by 596mm Base Unit Door (Right Hand Hinged)

Wall Units

25. 500mm Wall Unit, Depth = 300mm, Height = 720mm
1 X 715mm by 496mm Wall Unit Door (Left Hand Hinged)
26. 18mm End Support Panel (Door Colour), Depth = 300mm, Height = 720mm
27. 764mm Painted Shelf, Depth = 250mm, Height = 40mm
28. 764mm Painted Shelf, Depth = 250mm, Height = 40mm
29. 18mm End Support Panel (Door Colour), Depth = 300mm, Height = 740mm
30. 500mm Wall Unit, Depth = 300mm, Height = 720mm
1 X 715mm by 496mm Wall Unit Door (Right Hand Hinged)
31. 600mm Wall Unit, Depth = 300mm, Height = 720mm
1 X 715mm by 596mm Wall Unit Door (Left Hand Hinged)
32. 600mm Wall Unit, Depth = 300mm, Height = 720mm
1 X 715mm by 596mm Wall Unit Door (Right Hand Hinged)
33. 30mm Filler, Depth = 300mm, Height = 720mm

Accessories

Plinth (Total Length) = Circa 11500mm
 Cornice (Total Length) = Circa 3500mm
 Pelmet (Total Length) = Circa 2300mm

Appliances & Mechanisms

- 1 x Double Caddy Integrated Bin
- 1 x 70/30 Integrated Tall Fridge Freezer
- 1 x Single Oven
- 1 x Microwave (To Fit In A 600mm Tall Unit. Not A Combi Oven/Microwave)
- 1 x 4 Zone Induction Hob
- 1 x 150mm Wine Cooler
- 1 x 600mm Integrated Dishwasher
- 1 x Single Bowl Undermounted Sink (To Fit On A 600mm Base Unit)
- 1 x Tap
- 1 x Magic Corner Pull Out Mechanism (To Fit Behind A 600mm Door)

| | | | |
|---------------|--------------------|----------------------|--|
| Customer Name | Design Revision No | Design Revision Date | DESIGN A KITCHEN (UK) LIMITED |
| Sample Pack 2 | 1 | | Tel No Email enquiries@designakitchen.co.uk Web www.designakitchen.co.uk |

PLEASE NOTE: All dimensions are for guidance only. A thorough site survey should be conducted by the kitchen retailer and/or installer before any cabinets, accessories, appliances and worksurfaces are purchased to validate all dimensions and check technical suitability of all products.

KITCHEN WORKTOP / WORKSURFACE PLAN



Worktop 1 Specification

Worktop Materials: White Sparkle Quartz
 Worktop Thickness: 30mm
 Worktop Edge: Aris
 Matching Windowsill: 2312mm x 20mm (Width TBC)
 Matching Upstand(s): 100mm x 20mm
 Matching Windowsill Upstand(s): 180mm x 20mm
 Matching Island Upstand Riser: n/a
 Matching Splashback(s): n/a
 Cut-out(s) – 1 x Hob, 1 x Sink & 1 x Tap

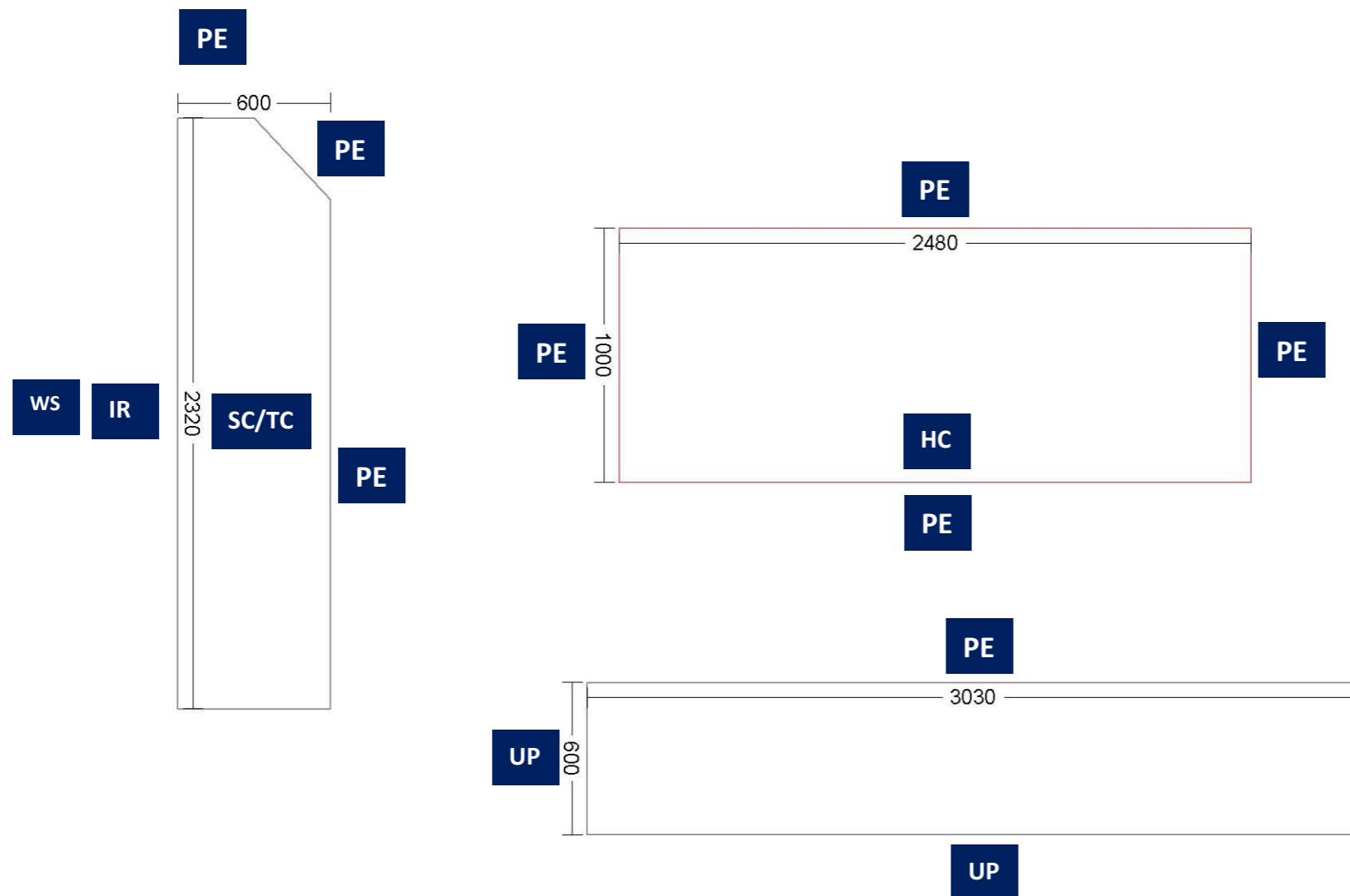

Key

- UP – Upstand
- UR – Upstand Riser
- IR – Island Upstand Riser
- WR – Windowsill Upstand Riser
- PE – Profile Edge
- WS – Windowsill
- DG – Drainer Grooves (x5)
- SC – Sink Cut-out
- HC – Hob Cut-out
- TC – Tap Cut-out

PLEASE NOTE: All dimensions are solely for the purpose of obtaining accurate quotations for your worksurfaces. Products should only be purchased following survey by your retailer/installer, or via templating by a worksurface specialist.

| | | | |
|---------------|--------------------|----------------------|--|
| Customer Name | Design Revision No | Design Revision Date | DESIGN A KITCHEN (UK) LIMITED |
| Sample Pack 2 | 1 | | Tel No Email enquiries@designakitchen.co.uk Web www.designakitchen.co.uk |

PLEASE NOTE: All dimensions are for guidance only. A thorough site survey should be conducted by the kitchen retailer and/or installer before any cabinets, accessories, appliances and worksurfaces are purchased to validate all dimensions and check technical suitability of all products.

KITCHEN ELEVATION PLAN - TALL UNIT WALL

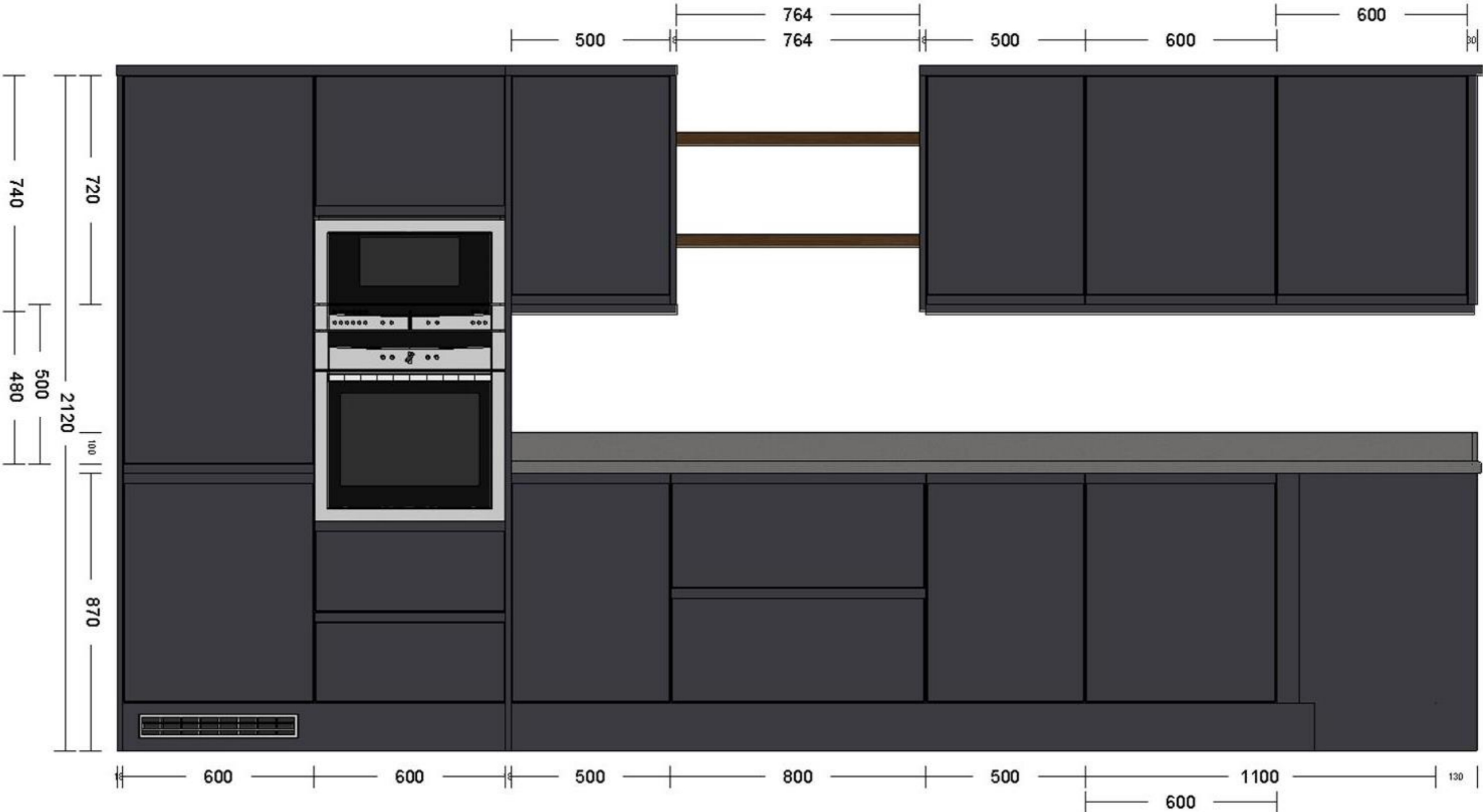

| | | | |
|---------------|--------------------|----------------------|--|
| Customer Name | Design Revision No | Design Revision Date | DESIGN A KITCHEN (UK) LIMITED |
| Sample Pack 2 | 1 | | Tel No Email enquiries@designakitchen.co.uk Web www.designakitchen.co.uk |

PLEASE NOTE: All dimensions are for guidance only. A thorough site survey should be conducted by the kitchen retailer and/or installer before any cabinets, accessories, appliances and worksurfaces are purchased to validate all dimensions and check technical suitability of all products.

KITCHEN ELEVATION PLAN – KITCHEN WINDOW WALL

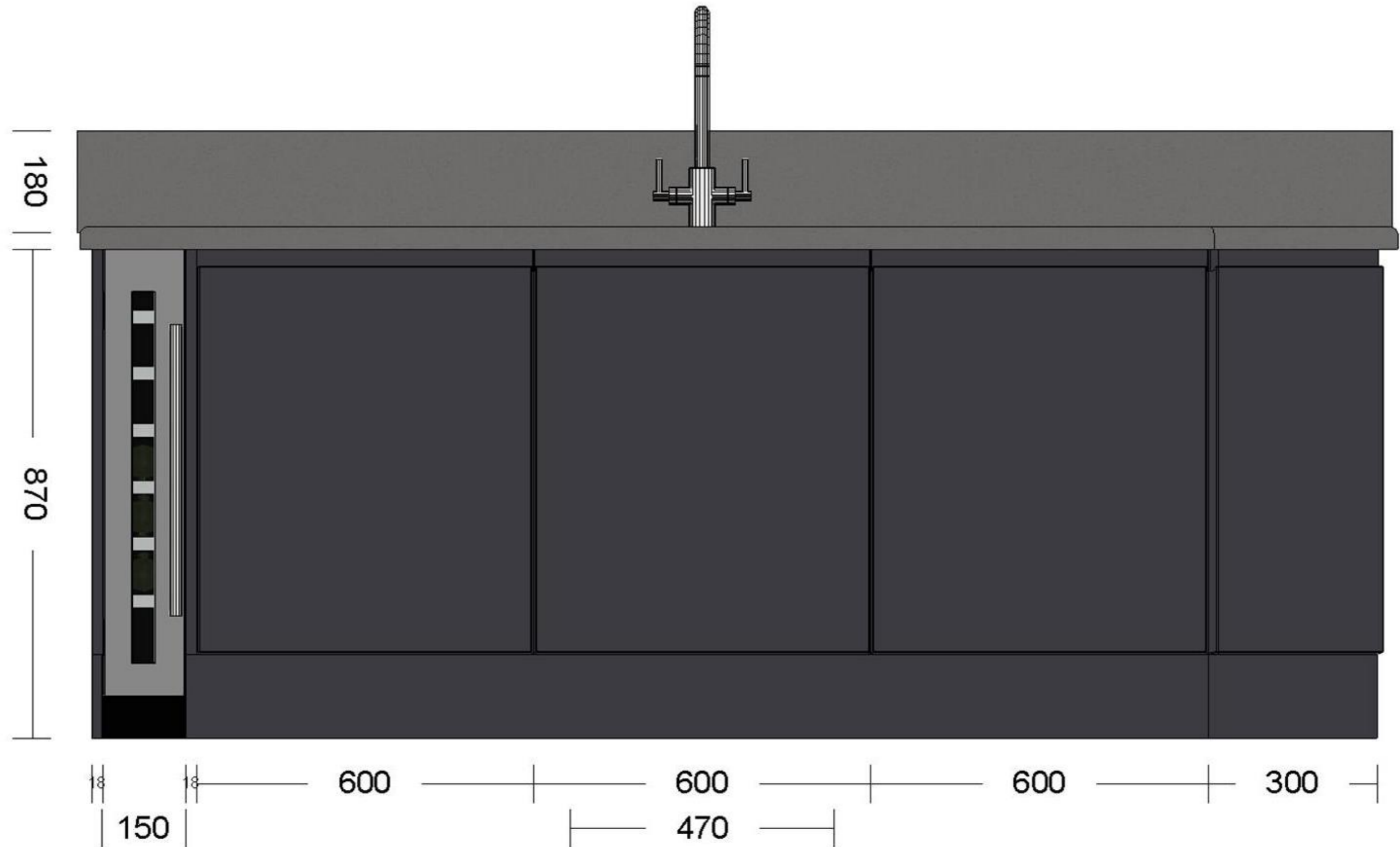

| | | | |
|---------------|--------------------|----------------------|--|
| Customer Name | Design Revision No | Design Revision Date | DESIGN A KITCHEN (UK) LIMITED |
| Sample Pack 2 | 1 | | Tel No Email enquiries@designakitchen.co.uk Web www.designakitchen.co.uk |

PLEASE NOTE: All dimensions are for guidance only. A thorough site survey should be conducted by the kitchen retailer and/or installer before any cabinets, accessories, appliances and worksurfaces are purchased to validate all dimensions and check technical suitability of all products.

KITCHEN ELEVATION PLAN – ISLAND DRAWER/HOB SIDE

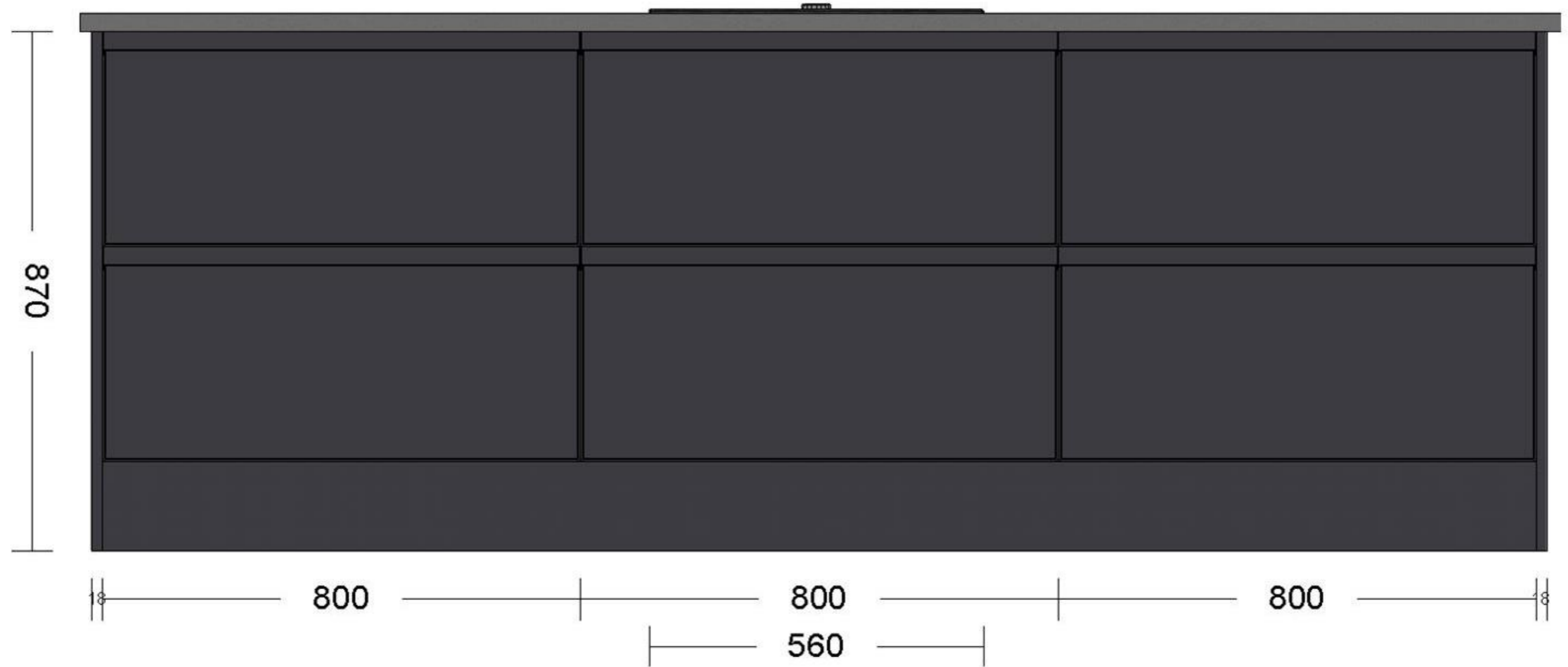

| | | | |
|---------------|--------------------|----------------------|--|
| Customer Name | Design Revision No | Design Revision Date | DESIGN A KITCHEN (UK) LIMITED |
| Sample Pack 2 | 1 | | Tel No Email enquiries@designakitchen.co.uk Web www.designakitchen.co.uk |

PLEASE NOTE: All dimensions are for guidance only. A thorough site survey should be conducted by the kitchen retailer and/or installer before any cabinets, accessories, appliances and worksurfaces are purchased to validate all dimensions and check technical suitability of all products.

KITCHEN ELEVATION PLAN – ISLAND SINK SIDE



| | | | |
|---------------|--------------------|----------------------|--|
| Customer Name | Design Revision No | Design Revision Date | DESIGN A KITCHEN (UK) LIMITED |
| Sample Pack 2 | 1 | | Tel No Email enquiries@designakitchen.co.uk Web www.designakitchen.co.uk |

PLEASE NOTE: All dimensions are for guidance only. A thorough site survey should be conducted by the kitchen retailer and/or installer before any cabinets, accessories, appliances and worksurfaces are purchased to validate all dimensions and check technical suitability of all products.

KITCHEN ELEVATION PLAN – ISLAND DINING SIDE



| | | | |
|---------------|--------------------|----------------------|--|
| Customer Name | Design Revision No | Design Revision Date | DESIGN A KITCHEN (UK) LIMITED |
| Sample Pack 2 | 1 | | Tel No Email enquiries@designakitchen.co.uk Web www.designakitchen.co.uk |

PLEASE NOTE: All dimensions are for guidance only. A thorough site survey should be conducted by the kitchen retailer and/or installer before any cabinets, accessories, appliances and worksurfaces are purchased to validate all dimensions and check technical suitability of all products.

KITCHEN ELEVATION PLAN – ISLAND SEATING SIDE

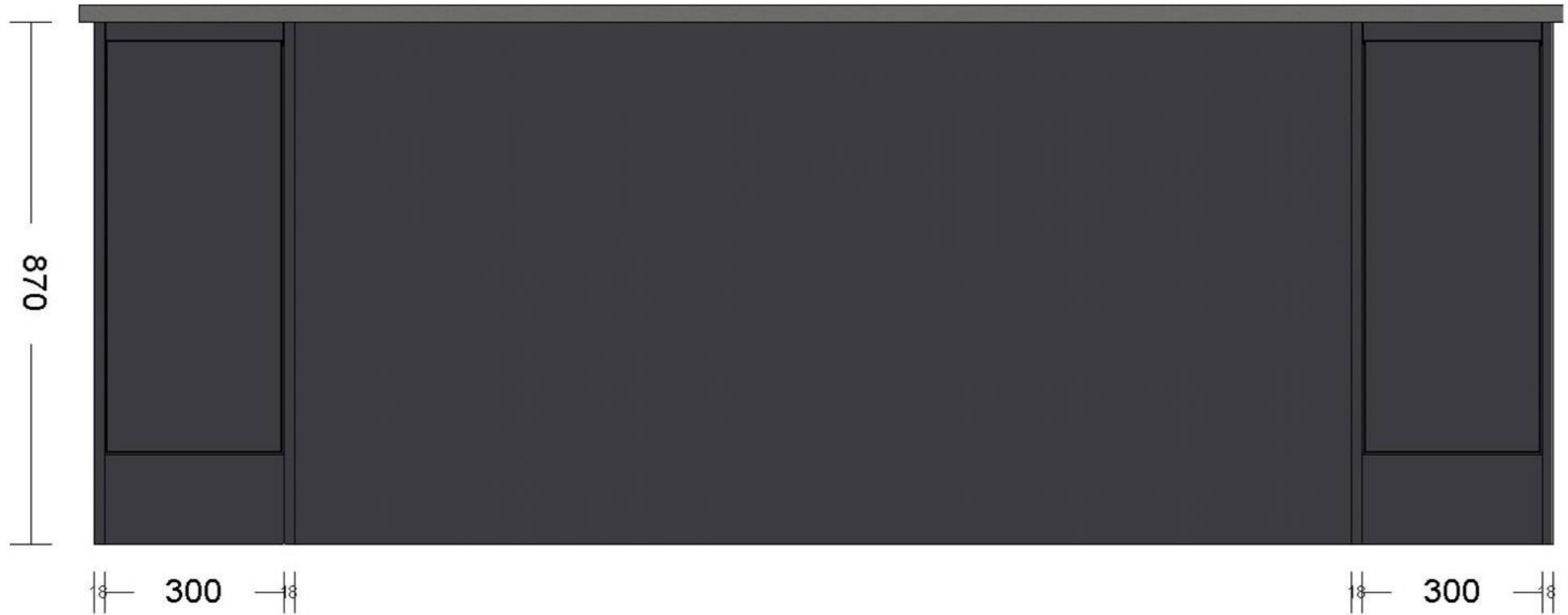

| | | | |
|---------------|--------------------|----------------------|--|
| Customer Name | Design Revision No | Design Revision Date | DESIGN A KITCHEN (UK) LIMITED |
| Sample Pack 2 | 1 | | Tel No Email enquiries@designakitchen.co.uk Web www.designakitchen.co.uk |

PLEASE NOTE: All dimensions are for guidance only. A thorough site survey should be conducted by the kitchen retailer and/or installer before any cabinets, accessories, appliances and worksurfaces are purchased to validate all dimensions and check technical suitability of all products.

UTILITY CAD VISUAL - BIRDSEYE



| Customer Name | Design Revision No | Design Revision Date | DESIGN A KITCHEN (UK) LIMITED |
|---------------|--------------------|----------------------|--|
| Sample Pack 2 | 1 | | Tel No Email enquiries@designakitchen.co.uk Web www.designakitchen.co.uk |

PLEASE NOTE: All dimensions are for guidance only. A thorough site survey should be conducted by the kitchen retailer and/or installer before any cabinets, accessories, appliances and worksurfaces are purchased to validate all dimensions and check technical suitability of all products.

UTILITY CAD VISUAL 1



| | | | |
|---------------|--------------------|----------------------|--|
| Customer Name | Design Revision No | Design Revision Date | DESIGN A KITCHEN (UK) LIMITED |
| Sample Pack 2 | 1 | | Tel No Email enquiries@designakitchen.co.uk Web www.designakitchen.co.uk |

PLEASE NOTE: All dimensions are for guidance only. A thorough site survey should be conducted by the kitchen retailer and/or installer before any cabinets, accessories, appliances and worksurfaces are purchased to validate all dimensions and check technical suitability of all products.

UTILITY CAD VISUAL 2



| | | | |
|---------------|--------------------|----------------------|--|
| Customer Name | Design Revision No | Design Revision Date | DESIGN A KITCHEN (UK) LIMITED |
| Sample Pack 2 | 1 | | Tel No Email enquiries@designakitchen.co.uk Web www.designakitchen.co.uk |

PLEASE NOTE: All dimensions are for guidance only. A thorough site survey should be conducted by the kitchen retailer and/or installer before any cabinets, accessories, appliances and worksurfaces are purchased to validate all dimensions and check technical suitability of all products.

KITCHEN CAD VISUAL 3



| Customer Name | Design Revision No | Design Revision Date | DESIGN A KITCHEN (UK) LIMITED |
|---------------|--------------------|----------------------|--|
| Sample Pack 2 | 1 | | Tel No Email enquiries@designakitchen.co.uk Web www.designakitchen.co.uk |

PLEASE NOTE: All dimensions are for guidance only. A thorough site survey should be conducted by the kitchen retailer and/or installer before any cabinets, accessories, appliances and worksurfaces are purchased to validate all dimensions and check technical suitability of all products.

UTILITY ANNOTATED WIREFRAME PLAN

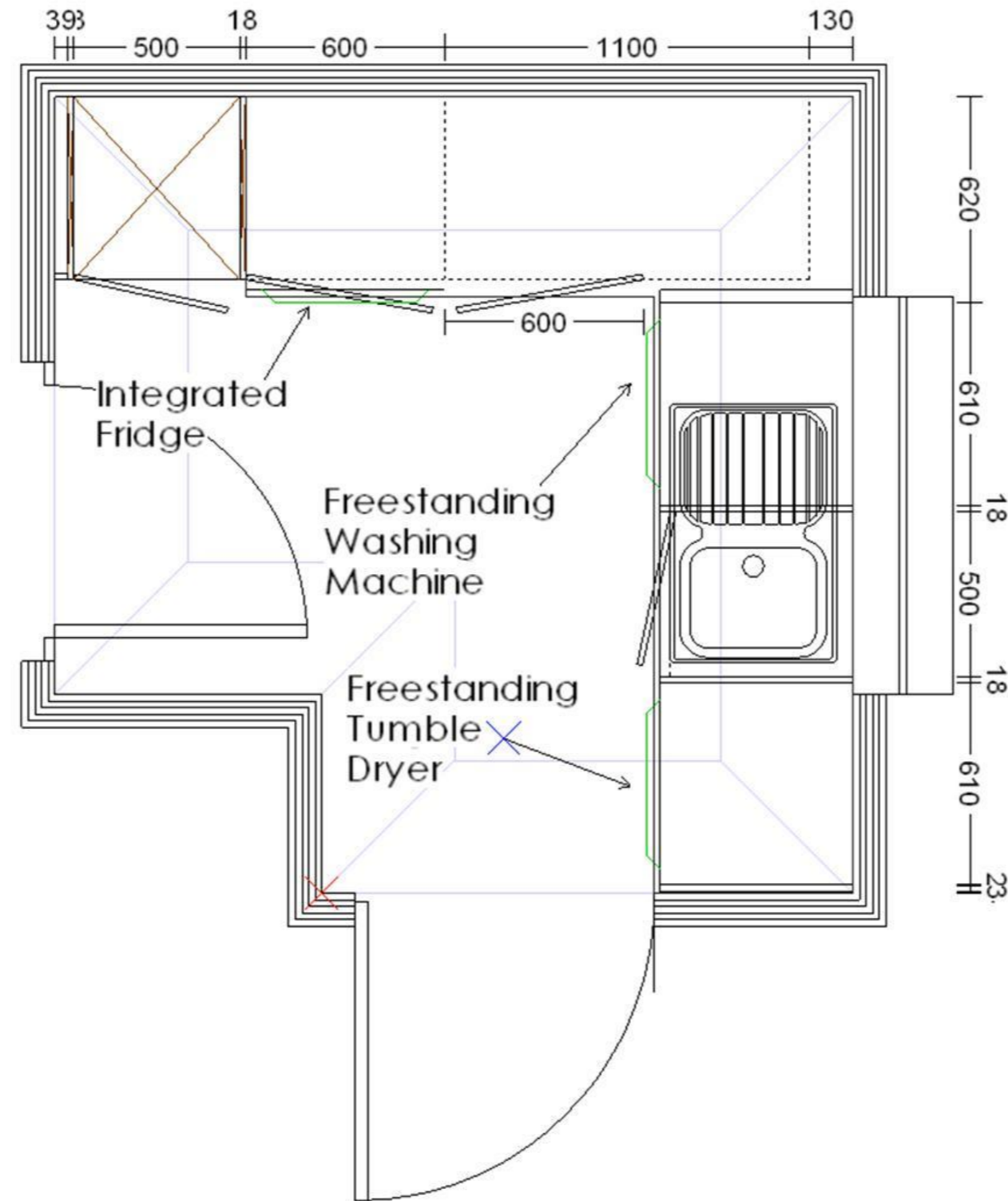

| | | | |
|---------------|--------------------|----------------------|--|
| Customer Name | Design Revision No | Design Revision Date | DESIGN A KITCHEN (UK) LIMITED |
| Sample Pack 2 | 1 | | Tel No Email enquiries@designakitchen.co.uk Web www.designakitchen.co.uk |

PLEASE NOTE: All dimensions are for guidance only. A thorough site survey should be conducted by the kitchen retailer and/or installer before any cabinets, accessories, appliances and worksurfaces are purchased to validate all dimensions and check technical suitability of all products.

UTILITY PART LIST WIREFRAME PLAN

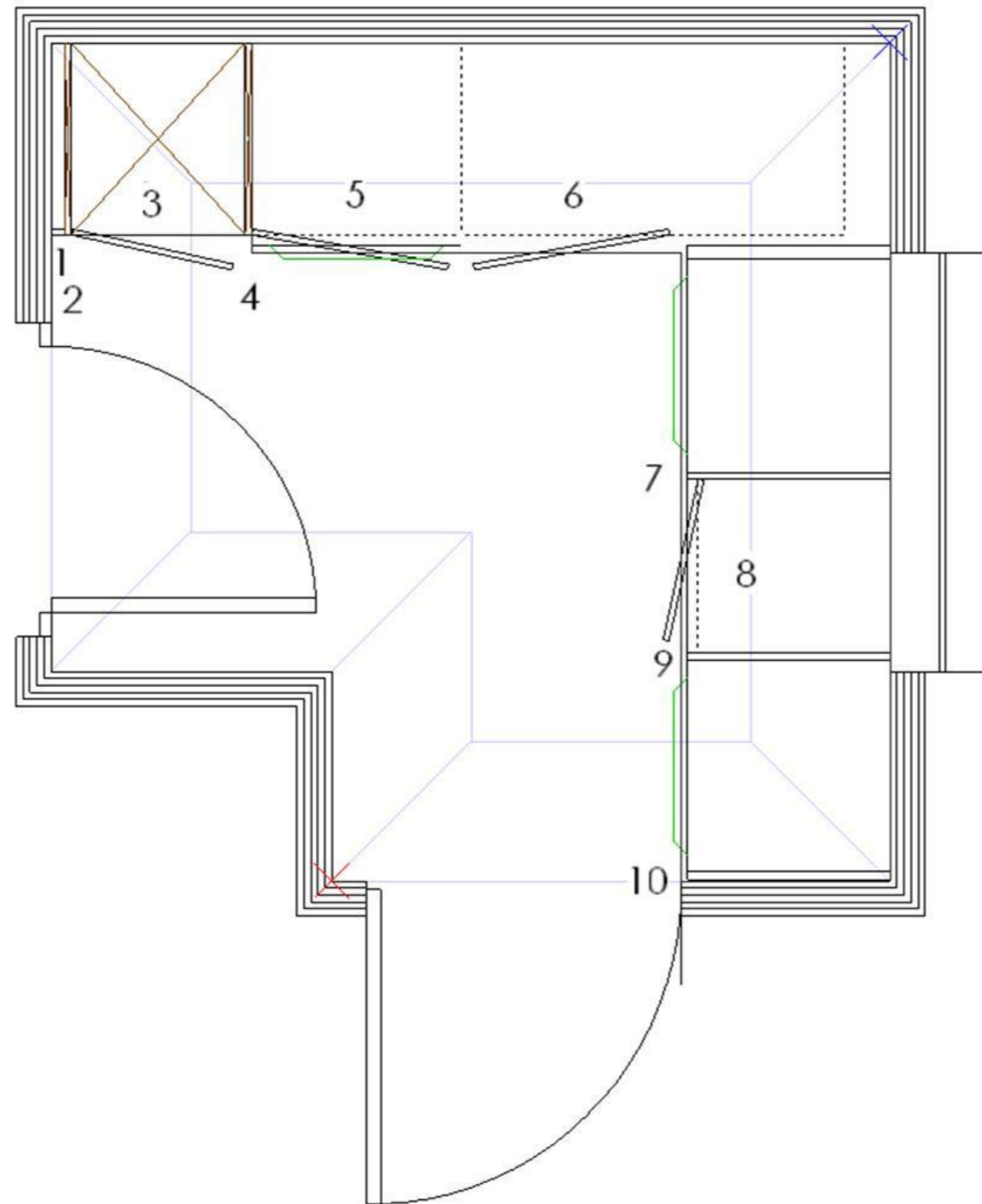

| | | | |
|---------------|--------------------|----------------------|--|
| Customer Name | Design Revision No | Design Revision Date | DESIGN A KITCHEN (UK) LIMITED |
| Sample Pack 2 | 1 | | Tel No Email enquiries@designakitchen.co.uk Web www.designakitchen.co.uk |

PLEASE NOTE: All dimensions are for guidance only. A thorough site survey should be conducted by the kitchen retailer and/or installer before any cabinets, accessories, appliances and worksurfaces are purchased to validate all dimensions and check technical suitability of all products.

UTILITY PART LIST WIREFRAME PLAN



Base & Tall Units

1. 39mm Tall Filler Flush, Depth = 580mm, Height = 2120mm
2. 18mm Tall End Support (Door Colour), Depth = 580mm, Height = 2120mm
3. 500mm Larder, Depth = 580mm, Height = 2120mm
1 X 1965mm by 496mm Base Unit Door (Left Hand Hinged)
4. 18mm Tall End Support (Door Colour), Depth = 580mm, Height = 2120mm
5. 600mm Integrated Appliance (Full Height Door), Depth = 580mm, Height = 870mm
1 X 715mm by 596mm Base Unit Door (Left Hand Hinged)
6. 1100mm Right Hand Corner Base (Full Height Door), Depth = 580mm, Height = 870mm
1 X 715mm by 596mm Base Unit Door (Right Hand Hinged)
7. 18mm End Support Panel (Door Colour), Depth = 580mm, Height = 870mm
8. 500mm Base Unit (Full Height Door), Depth = 580mm, Height = 870mm
1 X 715mm by 496mm Base Unit Door (Left Hand Hinged)
9. 18mm End Support Panel (Door Colour), Depth = 580mm, Height = 870mm
10. 24mm End Support Panel (Door Colour), Depth = 580mm, Height = 870mm

| Customer Name | Design Revision No | Design Revision Date | DESIGN A KITCHEN (UK) LIMITED |
|---------------|--------------------|----------------------|--|
| Sample Pack 2 | 1 | | Tel No Email enquiries@designakitchen.co.uk Web www.designakitchen.co.uk |

PLEASE NOTE: All dimensions are for guidance only. A thorough site survey should be conducted by the kitchen retailer and/or installer before any cabinets, accessories, appliances and worksurfaces are purchased to validate all dimensions and check technical suitability of all products.

UTILITY WORKTOP / WORKSURFACE PLAN



Worktop 1 Specification

- Worktop Materials: Laminate (Make/Model TBC)
- Worktop Thickness: 40mm
- Worktop Edge : TBC
- Matching Window sill: n/a
- Matching Upstand(s): n/a
- Matching Windowcill n/a
- Matching Island Upstand Riser: n/a
- Matching Splackback(s): n/a
- Cutout(s) – 1 x Sink & 1 x Tap

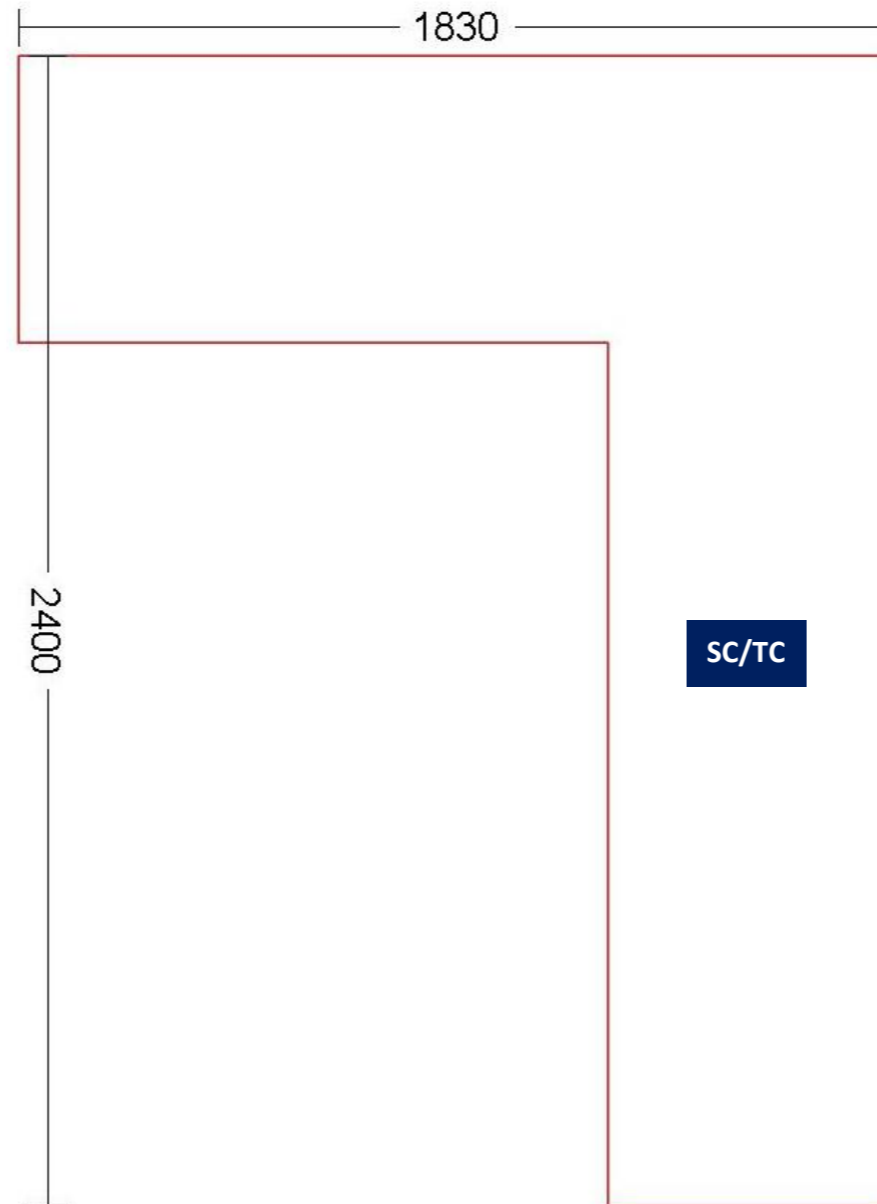

Key

- UP – Upstand
- UR – Upstand Riser
- IR – Island Upstand Riser
- WR – Windowsill Upstand Riser
- PE – Profile Edge
- WS – Windowsill
- DG – Drainer Grooves (x5)
- SC – Sink Cut-out
- HC – Hob Cut-out
- TC – Tap Cut-out

PLEASE NOTE: All dimensions are solely for the purpose of obtaining accurate quotations for your worksurfaces. Products should only be purchased following survey by your retailer/installer, or via templating by a worksurface specialist.

| | | | |
|---------------|--------------------|----------------------|--|
| Customer Name | Design Revision No | Design Revision Date | DESIGN A KITCHEN (UK) LIMITED |
| Sample Pack 2 | 1 | | Tel No Email enquiries@designakitchen.co.uk Web www.designakitchen.co.uk |

PLEASE NOTE: All dimensions are for guidance only. A thorough site survey should be conducted by the kitchen retailer and/or installer before any cabinets, accessories, appliances and worksurfaces are purchased to validate all dimensions and check technical suitability of all products.

UTILITY ELEVATION PLAN - TALL UNIT WALL

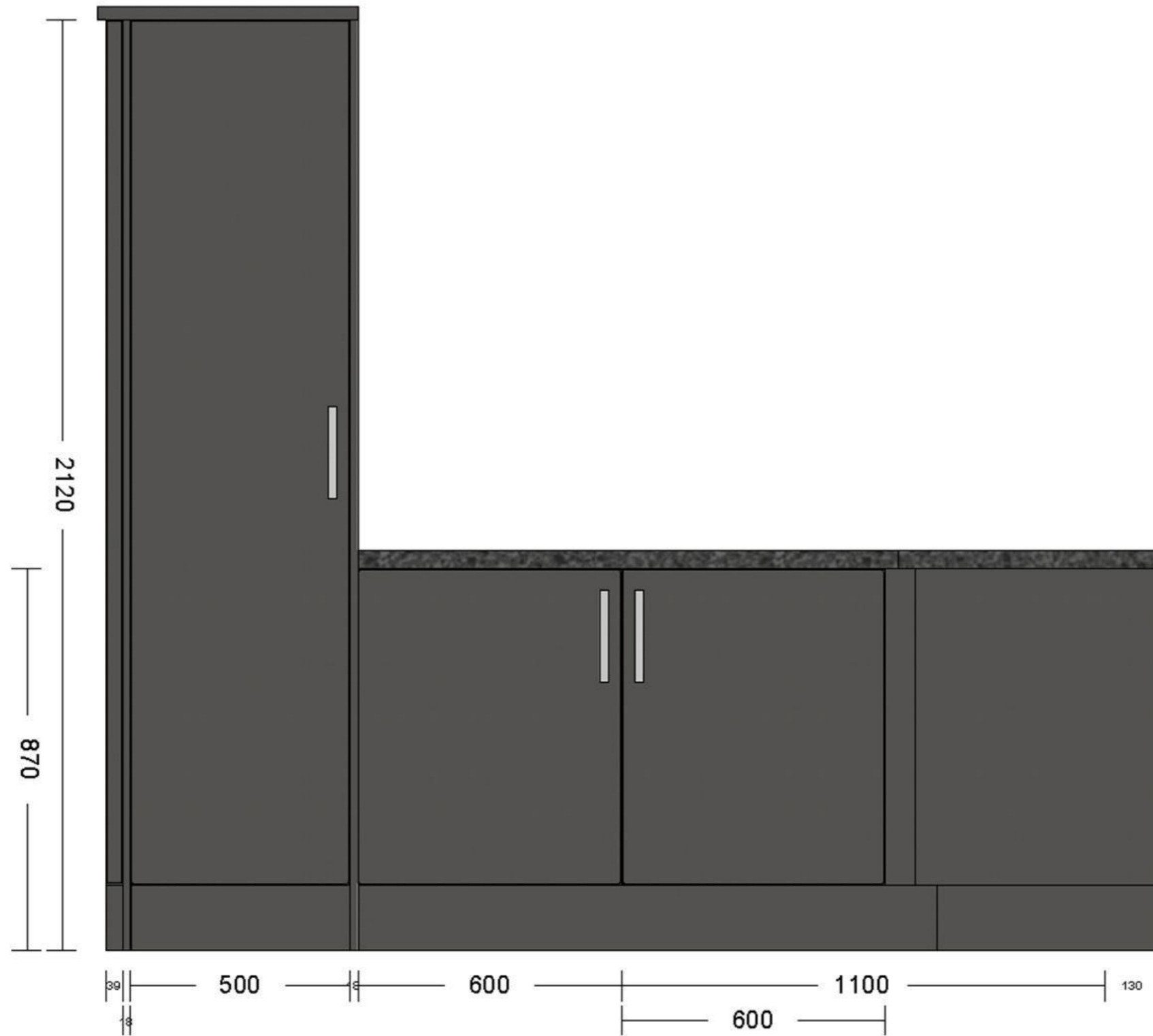

| | | | |
|---------------|--------------------|----------------------|--|
| Customer Name | Design Revision No | Design Revision Date | DESIGN A KITCHEN (UK) LIMITED |
| Sample Pack 2 | 1 | | Tel No Email enquiries@designakitchen.co.uk Web www.designakitchen.co.uk |

PLEASE NOTE: All dimensions are for guidance only. A thorough site survey should be conducted by the kitchen retailer and/or installer before any cabinets, accessories, appliances and worksurfaces are purchased to validate all dimensions and check technical suitability of all products.

UTILITY ELEVATION PLAN – WINDOW WALL

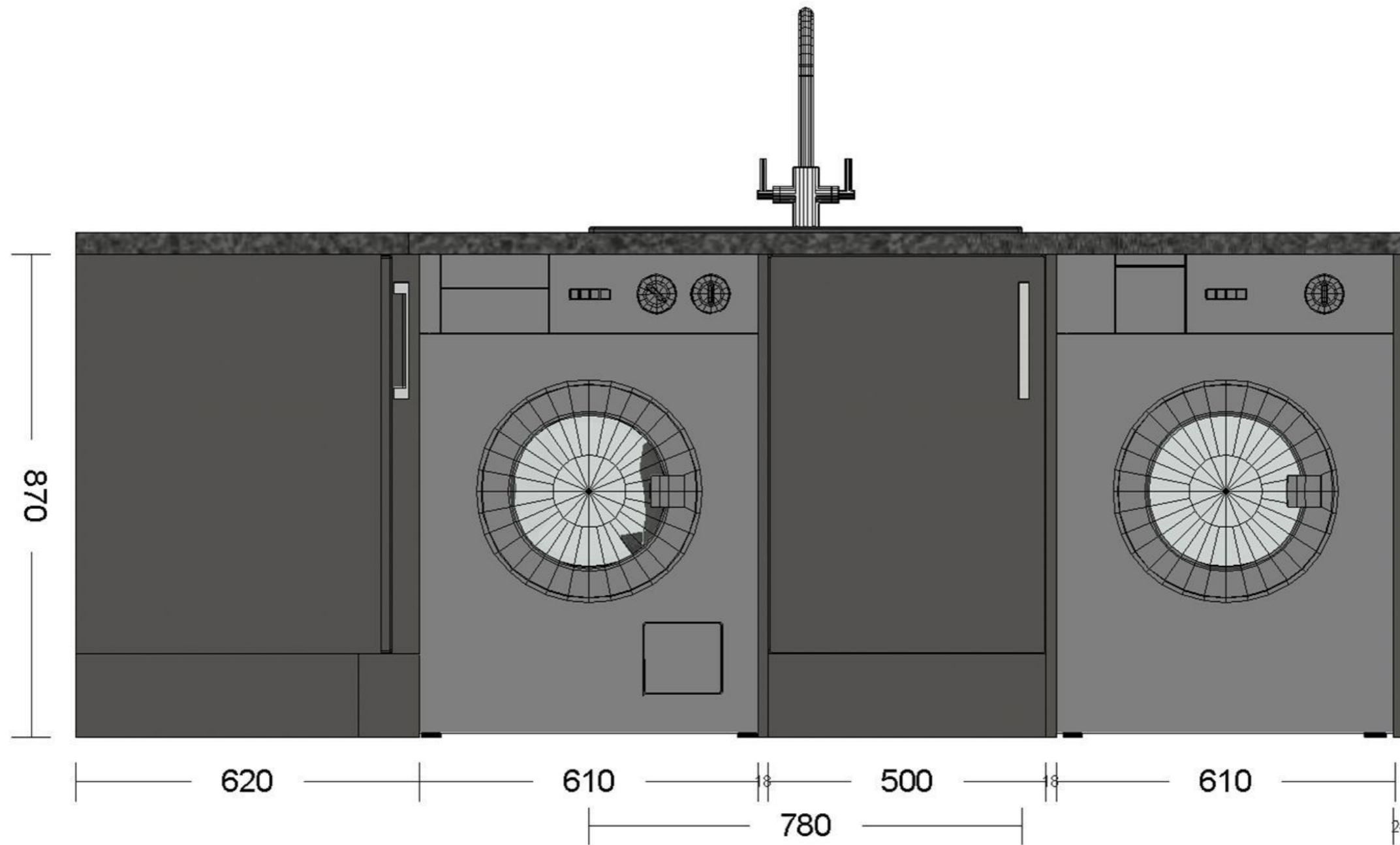

| | | | |
|---------------|--------------------|----------------------|--|
| Customer Name | Design Revision No | Design Revision Date | DESIGN A KITCHEN (UK) LIMITED |
| Sample Pack 2 | 1 | | Tel No Email enquiries@designakitchen.co.uk Web www.designakitchen.co.uk |

PLEASE NOTE: All dimensions are for guidance only. A thorough site survey should be conducted by the kitchen retailer and/or installer before any cabinets, accessories, appliances and worksurfaces are purchased to validate all dimensions and check technical suitability of all products.